

LEGAL DESCRIPTION FROM TAX RECORDS:

The East 12 acres of the West 22 acres of the East 1/2 of the Northwest 1/4, EXCEPT M-45 Right of Way, Section 25, T7N, R13W, Tallmadge Township, Ottawa County, Michigan.

C-2 AREA DESCRIPTION:
The North 1/2 of the The East 12 acres of the West 22 acres of the East 1/2 of the Northwest 1/4, EXCEPT M-45 Right of Way, Section 25, T7N, R13W, Tallmadge Township, Ottawa County, Michigan.

Notes:

1. A title insurance policy was not provided to this office at the time of the survey. One should be obtained to compare for accuracy of legal description and easements of record.
2. A boundary survey was not performed as part of this project.

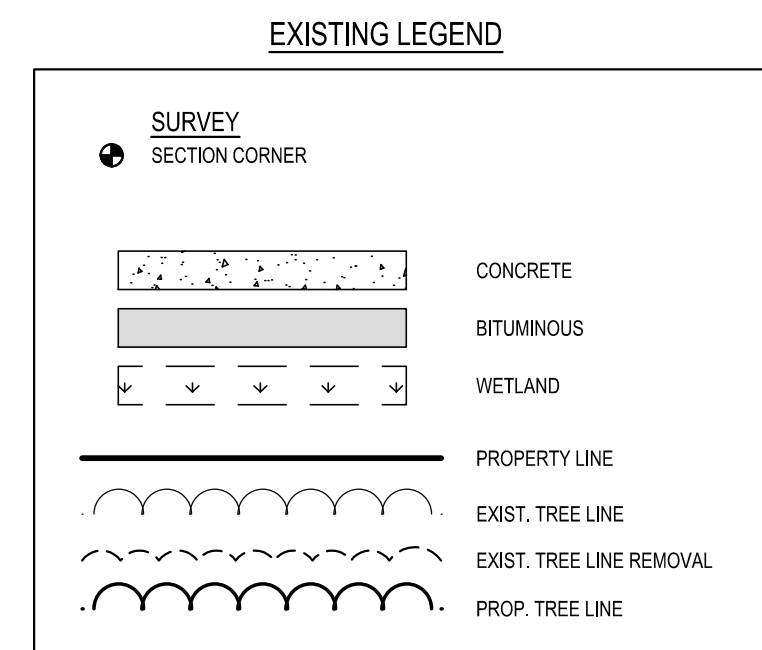
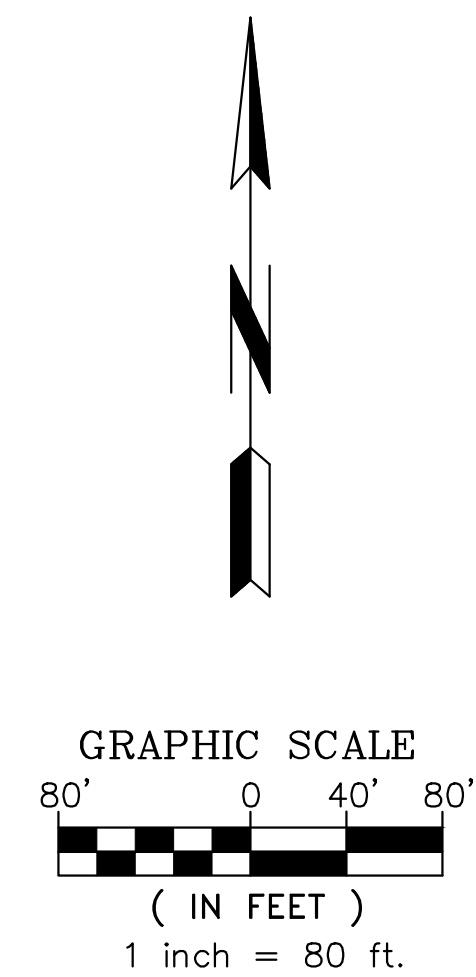

LEGEND

- - IRON STAKE - SET
- - IRON FLOOD
- ◇ - WOOD STAKE
- R - RECORDED DIMENSION
- D - DESCRIBED DIMENSION
- ME - MEASURED DIMENSION
- CL - CENTER LINE
- CORNER ON CONCRETE
- EB - EDGE OF BITUMINOUS
- EC - EDGE OF CONCRETE
- EO - EDGE OF GRAVEL
- G - GROUND ELEVATION
- GTR - FLOW LINE OF CUTTER
- OVERLAP - OVERLAP UTILITY LINE
- - LIGHT POLE
- - - EX. CONTOUR LINE
- CONC - CONCRETE
- FC - FENCE LINE
- CONC - CONCRETE
- BITUMINOUS PAVEMENT
- ENCR - EROSION LINE ENCROACHMENT
- UTL - UTILITY
- EL - ELECTRIC
- RET - RETAINING WALL
- P/L - PROPERTY LINE
- PAV - PAVEMENT
- W.S. - WATER SERVICE LATERAL
- B.V. - BENCHMARK
- W.V. - WATER VALVE
- HYD. - FIRE HYDRANT
- C.B. - CATCH BASIN
- MANH. - MANHOLE



**EXISTING CONDITIONS & REMOVALS PLAN
CONTRACTOR YARD**
550 LAKE MICHIGAN DRIVE, PART OF SECTION 25, T7N, R13W
TALLMADGE TOWNSHIP, OTTAWA COUNTY, MI

CLIENT:
MATT LARUE
O-308 LAKE MICHIGAN DR NW
GRAND RAPIDS, MI 49534
616-735-5530

C-101